

CHRISTIAN BROTHERS HIGH SCHOOL

PHASE 1 SCIENCE, MATH AND TECHNOLOGY WING

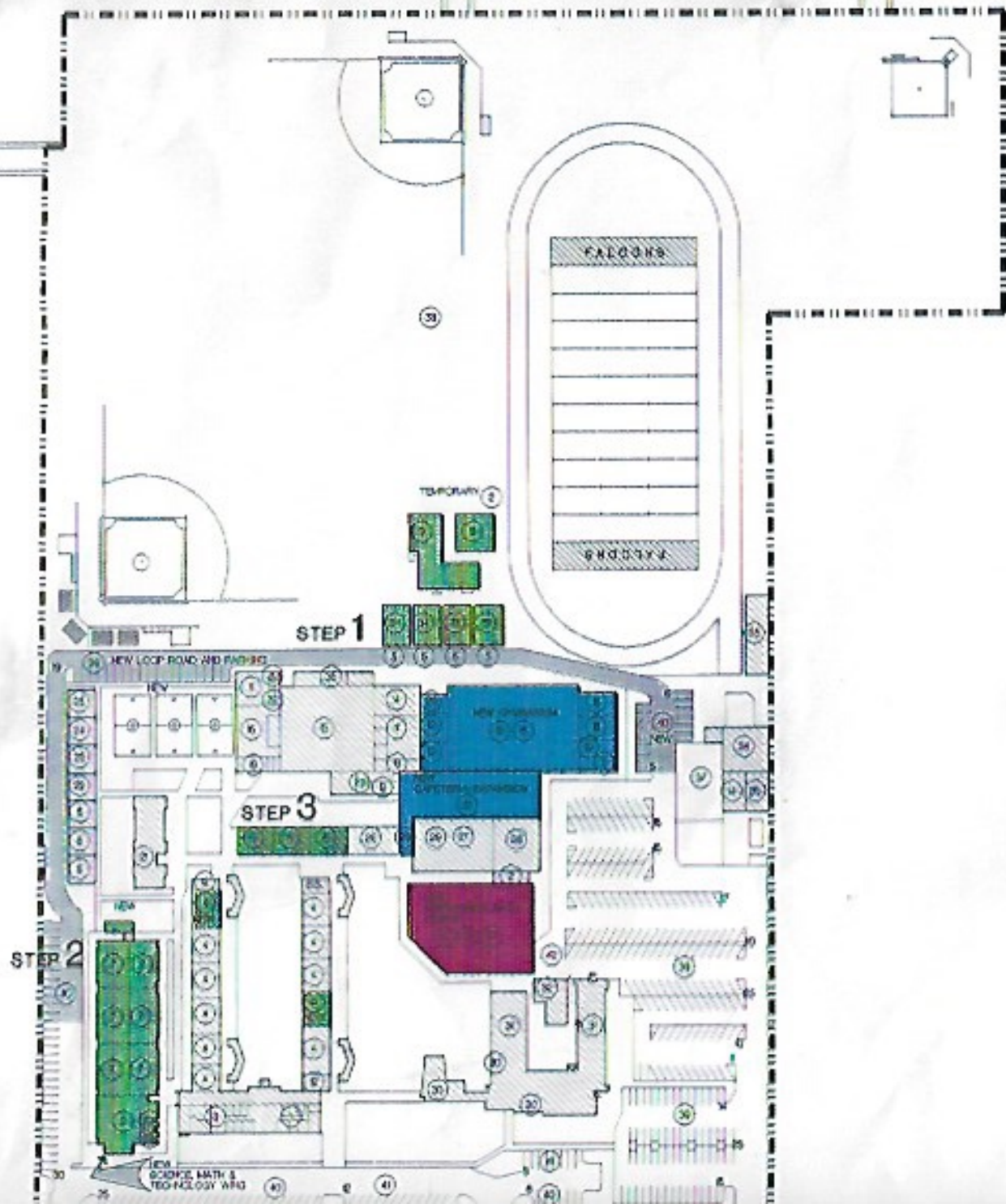

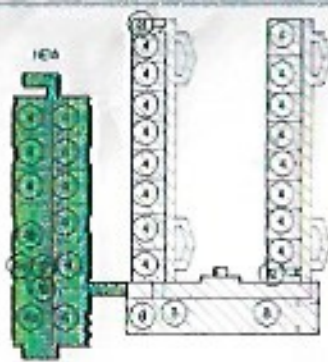

SCHEMATIC OF 2nd FLOOR
NEW SCIENCE, MATH & TECHNOLOGY WING

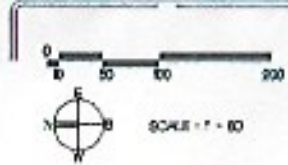

STUDENT POPULATION
CURRENT ENROLLMENT 955 STUDENTS
ULTIMATE ENROLLMENT 1001 STUDENTS

NEW BUILDING AREAS (IN S.F.)

PHASE 1		
• SCIENCE, MATH AND TECHNOLOGY WING	20,000	
PHASE 2		
• NEW GYMNASIUM	6,000	
• CAFETERIA EXPANSION	4,000	
PHASE 3	TOTAL	25,000
• NEW PERFORMING ARTS CENTER	7,470	

NEW BUILDING AREA GRAND TOTAL 50,000 SQF

Phase 1 Sequencing



Step 1

- RELOCATE FOUR EXISTING PORTABLE CLASSROOMS, MUSIC PORTABLES AND FACULTY LOUNGE PORTABLE TO EAST PART OF CAMPUS TENNIS COURTS.
- EXTEND AND CONNECT REQUIRED UTILITIES.

Step 2

- CONSTRUCT SCIENCE, MATH & TECHNOLOGY WING GENERAL CLASSROOM BUILDING AT NORTH PART OF CAMPUS. REHABILITATE LIBRARY TO ACCOMMODATE CORRIDOR, STUDENT TOILETS, FACULTY LOUNGE, ELEVATOR AND CIRCULATION WILL BE INCLUDED IN THIS BUILDING.
- CONSTRUCT NEW 45 SPACE PARKING AREA AND LOOP ROAD.

Step 3

- CONVERT EXISTING LABORATORIES INTO ARTS AND CRAFTS ROOMS AND STUDENT ACTIVITY CENTER.
- CONVERT EXISTING ARTS AND CRAFTS ROOMS INTO REGULAR CLASSROOMS.
- CONVERT OLD FACULTY LOUNGE PORTABLE INTO MUSIC PRACTICE ROOM.
- CONVERT RELOCATED PORTABLES INTO COACHES OFFICES.
- CONVERT RELOCATED PORTABLES INTO GENERAL STORAGE.

Phase 2 Sequencing



Step 1

- CONSTRUCT GYMNASIUM.

Step 2

- EXPAND CAFETERIA.

Phase 3 Sequencing



Step 1

- CONSTRUCT PERFORMING ARTS CENTER.



CARISWI • ROHRER • McMULLEN • ASSOCIATES
DATE 8-2-98